

REPLACEMENT PARTS SUITABLE FOR THERMAL DYNAMICS®

PCH/M28, PCH-26

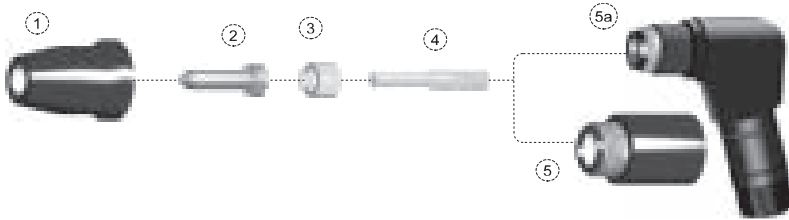

**Torch body features
our patented design
US Patent #6,271,497**

Item	Part No.	Ref. No.	Description	Std. Pkg.	Item	Part No.	Ref. No.	Description	Std. Pkg.
1.	T-0272	9-6003	Shield Cup	1		T-1331	9-6501	Tip, Drag, LongLife	10
	T-0273	9-6004	Shield Cup, Crown,*9-6003 req'd	1	3.	T-0269	9-6007	Gas Distributor	5
	T-1328	9-6503	Shield Cup, Long Life	1		T-1332	9-6507	Gas Distributor, Long Life	5
2.	T-0270	9-6000	Tip	10	4.	T-0103	9-6006	Electrode	10
	T-0271	9-6001	Tip, Drag	10		T-1333	9-6506	Electrode, Long Life	10
	T-1074	9-6002	Tip, Gouging	10	5.	T-0268	9-5809	Machine Torch	1
	T-2182	9-6502	Tip, Gouging, Long Life	10	5a.	T-0267**	9-5807DURA	Hand DURA-Torch 70°	1
	T-1329	9-6120	Tip, HD	10		T-1075	9-5808	Hand Torch 90°	1
	T-1330	9-6500	Tip, Stand Off, LongLife	10					

Note: PCH/M-28 uses only "LongLife" consumables.

ACCESSORIES

Hand Torch

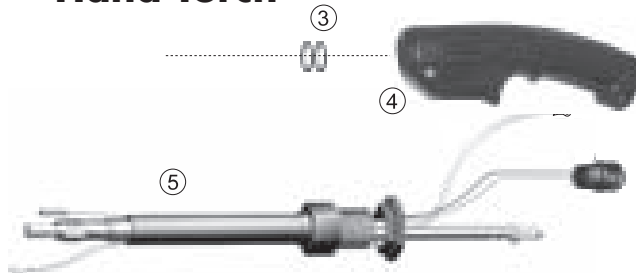

Machine Torch

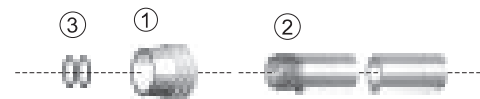

Item	Part No.	Ref. No.	Description	Std. Pkg.	Item	Part No.	Ref. No.	Description	Std. Pkg.
1.	T-0157	8-4018	Nut	1	NS T-2285	2-3501		Torch 70° with Leads 12.5'	1
3.	T-1077	7-3207*	Mounting Tube	1	NS T-2286	2-3511		Torch 70° with Leads 25'	1
7.	T-0122	8-0533	O-Ring	10	NS T-2287	2-3500		Torch 90° with Leads 12.5'	1
8.	T-1040	9-5636-1	Handle with switch	1	NS T-2288	2-3510		Torch 90° with Leads 25'	1
9.	T-2273	4-2895	Leads, Hand, 25'	1	NS T-0734	2-5001		Torch 70° with Leads 25'	1
	T-2888	4-6071	Torch Leads, 12.5'	1	NS T-0735	2-5002		Torch 70° with Leads 50'	1
	T-0763	4-6072	Torch Leads, 25'	1	NS T-2892	2-5003		Torch 90° with Leads 25'	1
NS	T-0155	8-1322*	Retaining Sheath	1	NS T-4551	2-5004		Torch 90° with Leads 50'	1

** A UNIQUE DESIGN WHICH ENHANCES PERFORMANCE AND DIFFERS FROM OEM DESIGNS