

REPLACEMENT PARTS SUITABLE FOR THERMAL DYNAMICS®

PCH/M-75, PCH/M-76

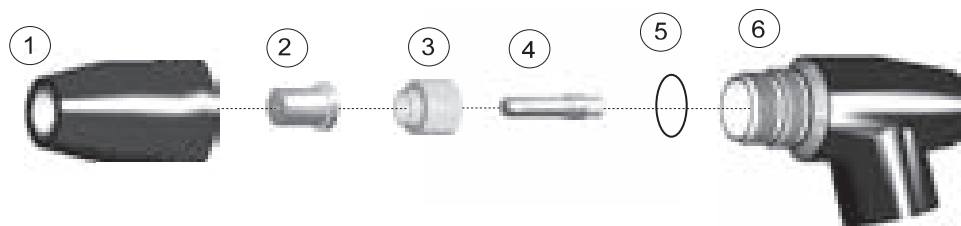

Item	Part No.	Ref. No.	Description	Std. Pkg.	Item	Part No.	Ref. No.	Description	Std. Pkg.
1.	T-1609	8-7500	Shield Cap	1	T-1708	8-7506	Gouging Tip	5	
	T-1706	8-7507	Crown Shield Cup	1	3.	T-1611	8-7501	Gas Distributor	5
	T-3761	8-7499	Crown Shield, Copper	1	T-1709	8-7508	Gouging Gas Distributor	1	
2.	T-1610	8-7504	Tip, 55 Amp	5	4.	T-1612	8-7502	Electrode	10
	T-2535	9-7726	Tip, 60 Amp	5	5.	T-1615	8-0532	O-Ring	1
	T-2534	9-7728	Tip, 80 Amp	5	6.	T-1613	8-7510	Torch Body 70°	1
	T-2126	8-7505	Tip, 70 Amp	5	T-2308	8-7512	Torch Body, Machine	1	
	T-1707	8-7503	Drag Tip, 35 Amp	5	NS	T-2183	9-7501*	Coil Spring	1

ACCESSORIES

Hand Torch

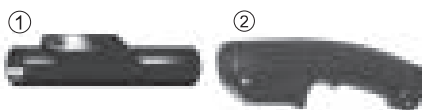

Machine Torch

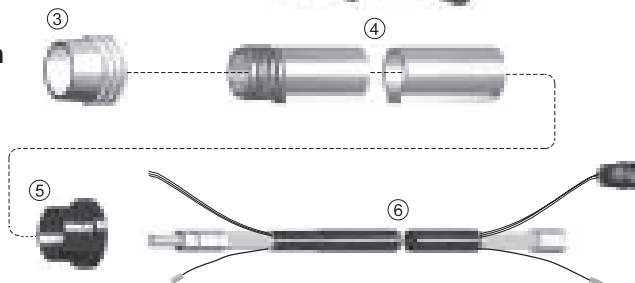

Item	Part No.	Ref. No.	Description	Std. Pkg.	Item	Part No.	Ref. No.	Description	Std. Pkg.
1.	T-0155	8-1322	Retaining Sheath	1	NS	T-1713	4-7502	Machine Leads, NonShielded, 25'	1
2.	T-1040	9-5636-1	Handle with Switch	1	NS	T-1714	4-7503	Machine Leads, NonShielded, 50'	1
3.	T-0157	8-4018	Nut	1	NS	T-2896	2-0001	100XL Torch 70° with 25' Leads	1
4.	T-0159	8-5005	Mounting Tube	1	NS	T-2897	2-0002	100XL Torch 70° with 50' Leads	1
5.	T-0161	8-4204	Bushing	1	NS	T-2890	2-7501	75 Torch, 70° with 25' Leads	1
6.	T-1711	4-7500	Hand Leads, NonShielded, 25'	1	NS	T-2891	2-7502	75 Torch, 70° with 50' Leads	1
	T-1712	4-7501	Hand Leads, NonShielded, 50'	1	NS	T-2919	4-7611	25' Leads	1
	T-0759	4-0010	Hand Leads, 100XL, NonShielded, 25'	1	NS	T-2920	4-7612	50' Leads	1

VERIFY POWER SUPPLY WHEN ORDERING LEADS