

# REPLACEMENT PARTS SUITABLE FOR THERMAL DYNAMICS®

## PCH/M-53 TORCH

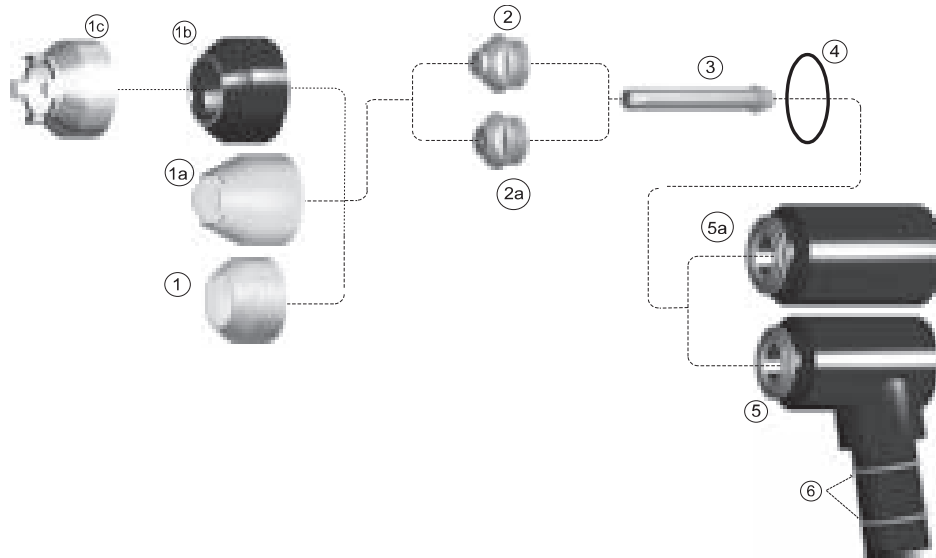

Item	Part No.	Ref. No.	Description	Std. Pkg	Item	Part No.	Ref. No.	Description	Std. Pkg.
1.	T-0166	9-5617	Shield Cup	10	4.	T-0151	8-5525	O-Ring	10
1a.	T-0168	9-5694	Crown Shield Cup	10	5.	T-1335	9-6170	Hand Torch with Handle	1
	T-0169	9-5694-1	Crown Shield Cup, SR	1	5a.	T-1336	9-6180	Machine Torch	
1b.	T-0186	9-5781	Shield Cup, Long, SR	1	NS	T-0185	8-5130*	Heat Shield	1
1c.	T-0188	9-5780	Shield Cup, Metal	1	NS	T-0189	8-4007	Tip Wrench	1
2.	T-1312	9-5897	Tip, Cutting	10	NS	T-0190	9-5620	Electrode Wrench	10
2a.	T-1313	8-5129	Tip, Gouging	5	NS	T-0163	8-4025	Lubricant	1
3.	T-0176	9-5619	Electrode, Air	10					

## ACCESSORIES

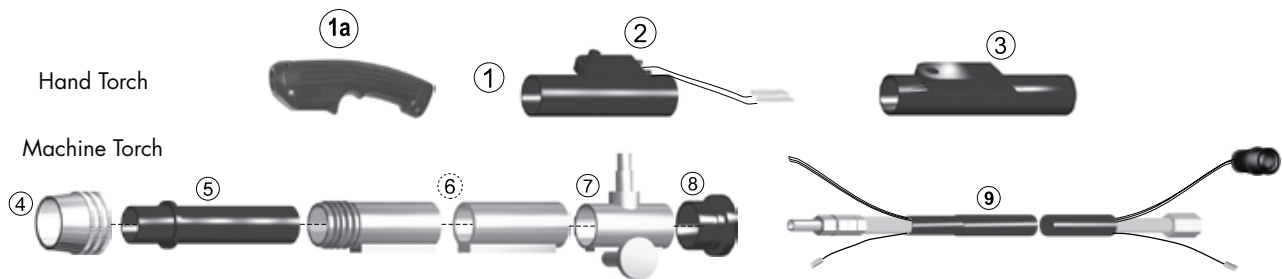

Item	Part No.	Ref. No.	Description	Std. Pkg	Item	Part No.	Ref. No.	Description	Std. Pkg.
1.	T-0180*	9-5644	Handle	1	7.	T-0160*	7-2827	Pinion Assembly	1
1a.	T-1040	9-5636-1	Handle with Switch	1	8.	T-0161	8-4204	Bushing	1
2.	T-0181	9-5522	Switch	1	9.	T-1674	4-6048	Hand Leads, 25'	1
3.	T-0182*	8-4216	Retaining Sheath	1		T-1675	4-6050	Hand Leads, 50'	1
4.	T-0157	8-4018	Nut	1		T-1676	4-6049	Machine Leads, 25'	1
5.	T-0183*	9-1901	Adapter	1		T-1677	4-6051	Machine Leads, 50'	1
6.	T-0159	8-5005	Mounting Tube	1					