

# REPLACEMENT PARTS SUITABLE FOR THERMAL DYNAMICS®

## PCH/M-35, PCH/M-40

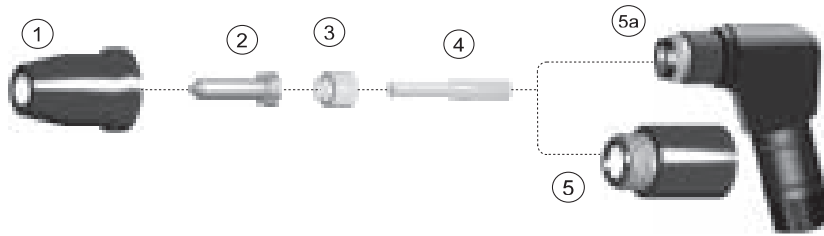

**Torch body features  
our patented design  
US Patent #6,271,497**

Item	Part No.	Ref. No.	Description	Std. Pkg	Item	Part No.	Ref. No.	Description	Std. Pkg.
1.	T-0272	9-6003	Shield Cup	1	T1331	9-6501	Tip, Drag, Long Life		10
	T-0273	9-6004	Shield Cup, Crown,*9-6003, Req'd	1	3.	T-0269	9-6007	Gas Distributor	5
	T-1328	9-6503	Shield Cup, Long Life	10		T-1332	9-6507	Gas Distributor, Long Life	5
2.	T-0270	9-6000	Tip	10	4.	T-0103	9-6006	Electrode	10
	T-1074	9-6001	Tip, Drag	10		T-1333	9-6506	Electrode, Long Life	10
	T-1329	9-6002	Tip, Gouging	10	5.	T-0268	9-5809	Machine Torch	1
	T-1330	9-6120	Tip, HD	10	5a.	T-1075	9-5808	Hand Torch 90°	1
	T-2182	9-6502	Tip Gouging, Long Life	10		T-0267**	9-5807DURA	Hand Dura Torch, 70°	1
	T-1331	9-6500	Tip, Stand Off, Long Life	10					

## ACCESSORIES

### Machine Torch

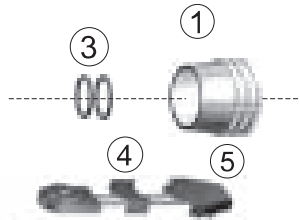

### Hand Torch

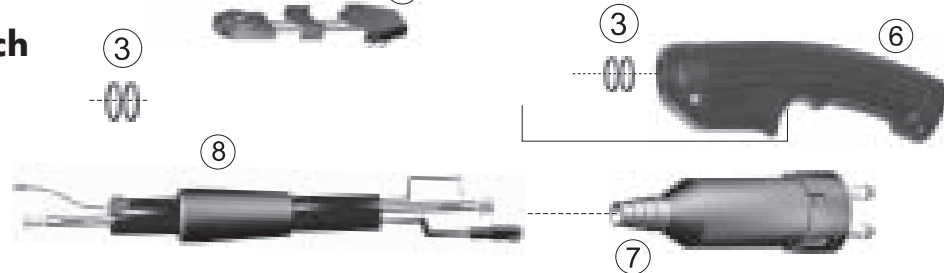

Item	Part No.	Ref. No.	Description	Std. Pkg	Item	Part No.	Ref. No.	Description	Std. Pkg.
1.	T-0157	8-4018	Nut	1	8.	T-1926	2-6057	Torch 90° with Leads, 50' & QD	1
2.	T-1077	7-3207	Mounting Tube	1		T-1921	2-6052	Torch 70° with Leads, 12.5' & QD	1
3.	T-0122	8-0533	O-Ring	1		T-1922	2-6053	Torch 70° with Leads, 25' & QD	1
4.	T-1623	8-4302*	Switch Insert	1		T-1923	2-6054	Torch 70° with Leads, 50' & QD	1
5.	T-1624	8-4303*	Switch Closure	1		T-1924	2-6055	Torch 90° with Leads, 12.5' & QD	1
6.	T-1040	9-5636-1	Handle	1		T-1925	2-6056	Torch 90° with Leads, 12.5' & QD	1
7.	T-1633	9-5836*	Quick Disconnect	1	NS	T-1081	9-6103	PIP Wire Assy	1

\*\* A UNIQUE DESIGN WHICH ENHANCES PERFORMANCE AND DIFFERS FROM OEM DESIGNS