

REPLACEMENT PARTS SUITABLE FOR TRAFIMET®

R145 (Hand) / R145P (Machine)

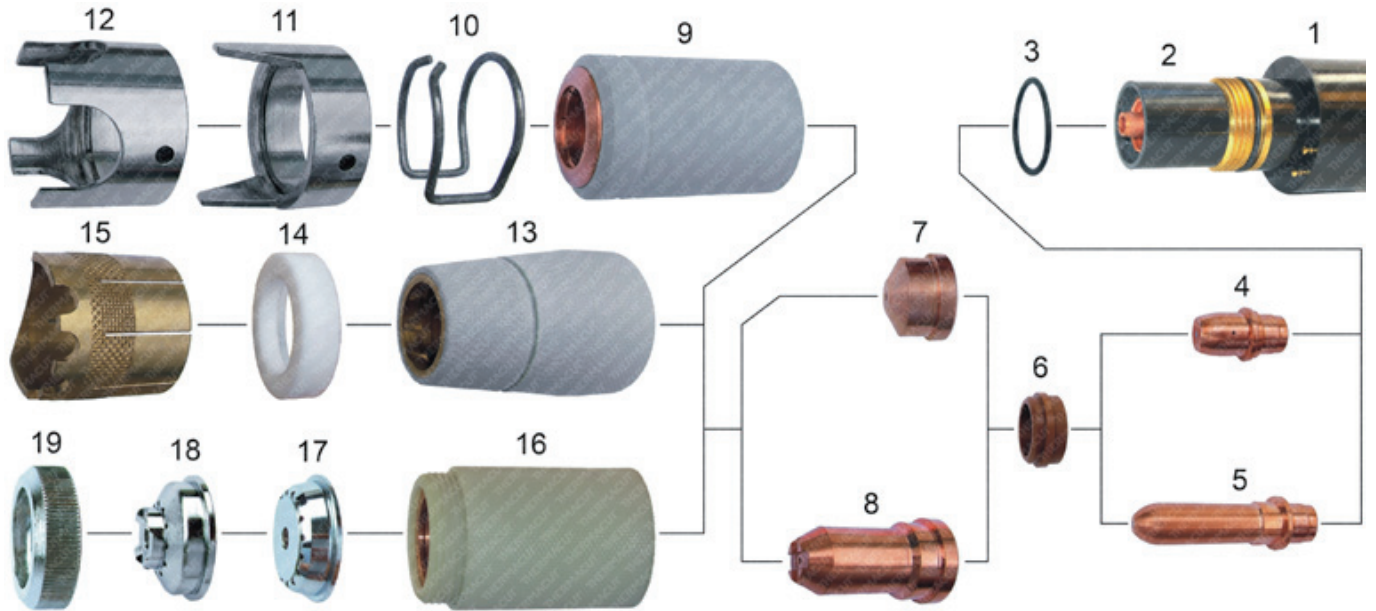

Item	Part No.	Ref. No.	Description	Std. Pkg.	Item	Part No.	Ref. No.	Description	Std. Pkg.
1.	T-5050	PF112	Torch Body, Hand	1	11.	T-0643	CV12	Double Pointed Spacer	1
	T-5049	PF111	Torch Body, Machine	1	12.	T-5003	CV14	Crown Spacer	6
2.	T-11289	T-11289	Insulator (only for TMT torch)	1	13.	T-5017	PC120	Nozzle Retaining Cap	1
3.	T-3562	EA131	O - Ring	1	14.	T-5000	BW139	Nozzle Shield	10
4.	T-5064	PR111	Electrode	5	15.	T-5001	CV1105	Cage Spacer	1
5.	T-5065	PR116	Electrode, Long – no thread	5	16.	T-5013	PC103	Contact Nozzle Retaining Cap	1
6.	T-5040	PE103	Swirl Ring	2	17.	T-9372		Shield Cup, Machine	1
7.	T-5027	PD109-14	Nozzle 1,4mm	5	18.	T-9371		Spacer for Contact Cutting	1
	T-5028	PD109-16	Nozzle 1,6mm	5	19.	T-9375		Locking Nut	1
	T-5029	PD109-18	Nozzle 1,8mm	5	NS	T-5069	TP12	Insulating Sleeve	1
8.	T-5032	PD117-14	Nozzle, Long 1,4mm	10	NS	T-5068	TP10	Handle with Switch	1
	T-5033	PD117-17	Nozzle, Long 1,7mm	10	NS	KT-1446	PA218	Hand Torch 6m, fittings	1
	T-5034	PD117-19	Nozzle, Long 1,9mm	10	NS	KT-1129	PA250	R145® Hand Torch 6m, centr.conn.	1
9.	T-10409	PC101	Nozzle Retaining Cap	1	NS	KT-1074	PH151	R145® Cable Leads 12m, Hand, centr.conn.	1
10.	T-3718	CV11	Spacer Spring	5					

NS NOT SHOWN IN THE PICTURE