

REPLACEMENT PARTS SUITABLE FOR HYPERTHERM®

HT4000®
PAC170®/PAC600®

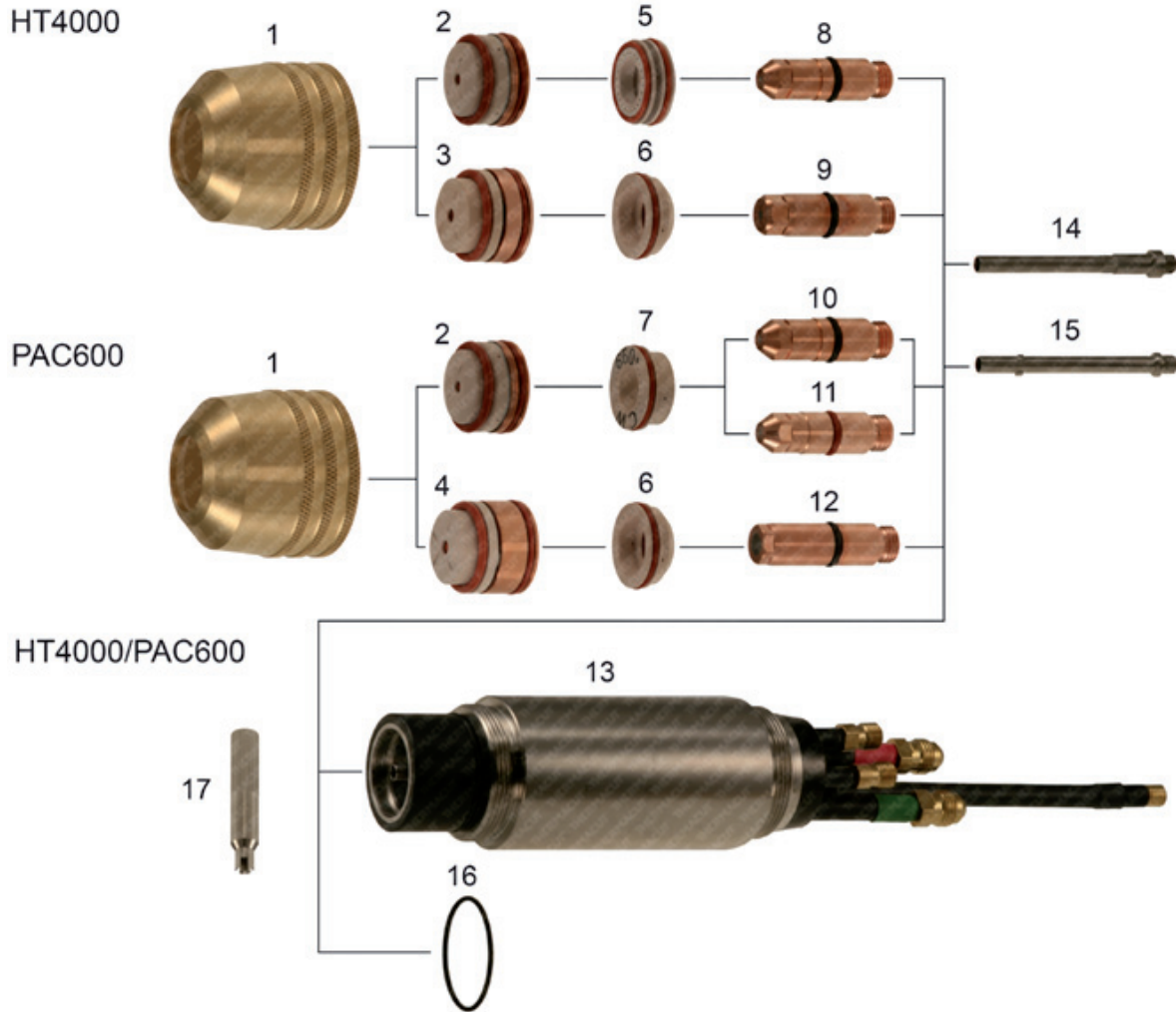

Item	Part No.	Ref. No.	Description	Std. Pkg.	Item	Part No.	Ref. No.	Description	Std. Pkg.
1.	T-0088	020579	Cap, Nozzle Retaining	1	T-1003	020391	Swirl Ring, .099 (ccw)	1	
2.	T-0078	020086	Nozzle, .099 Oxygen	1	8.	T-1293	020663	Electrode, PAC170®, Oxygen	5
3.	T-0080	020084	Nozzle, .166 Nitrogen	1	9.	T-0084	020082	Electrode, Nitrogen	5
4.	T-0509	020281	Nozzle, .120 Nitrogen	1	10.	T-0083	020081	Electrode, Oxygen	5
	T-0510	020282	Nozzle, 166 Nitrogen	1	11.	T-1382	120090	Electrode, Oxygen	5
	T-0511	020283	Nozzle, .187 Nitrogen	1	12.	T-0499	020285	Electrode, Nitrogen	5
	T-0512	020284	Nozzle, .220 Nitrogen	1	13.	T-1393	020328	Torch Body PAC170®/PAC600®/PAC620®	1
5.	T-1292	020623	Swirl Ring, PAC170®	1	#14.	T-1389#	020990 OEM	Water Tube (For OEM Torch)	1
	T-2927	120015	Swirl Ring, Bevel, CCW	1	**15.	T-1388**	020990-UR	Water Tube (For TMT Torch)	1
6.	T-0020	020039	Swirl Ring, .120	1	16.	T-1006	044028	O-Ring	1
7.	T-1002	020380	Swirl Ring, .099	1	17.	T-1397	T-1397	Wrench for TMT Water Tube	1

Compatible with OEM torch only, doesn't fit to Thermacut torch

** Compatible with Thermacut and OEM torch

CCW Counter Clock Wise gas swirling, use of CCW parts will make cut angle on the opposite side, than with standard Counter Wise (CW) swirling parts.

HYPERTHERM®, HT4000®, PAC620®, PAC600®, PAC170® are the Registered Trademarks of HYPERTHERM, Inc.

Last update of this page: 16/08/2014. See Revision history for details.