

REPLACEMENT PARTS SUITABLE FOR HYPERTHERM®

HT400®

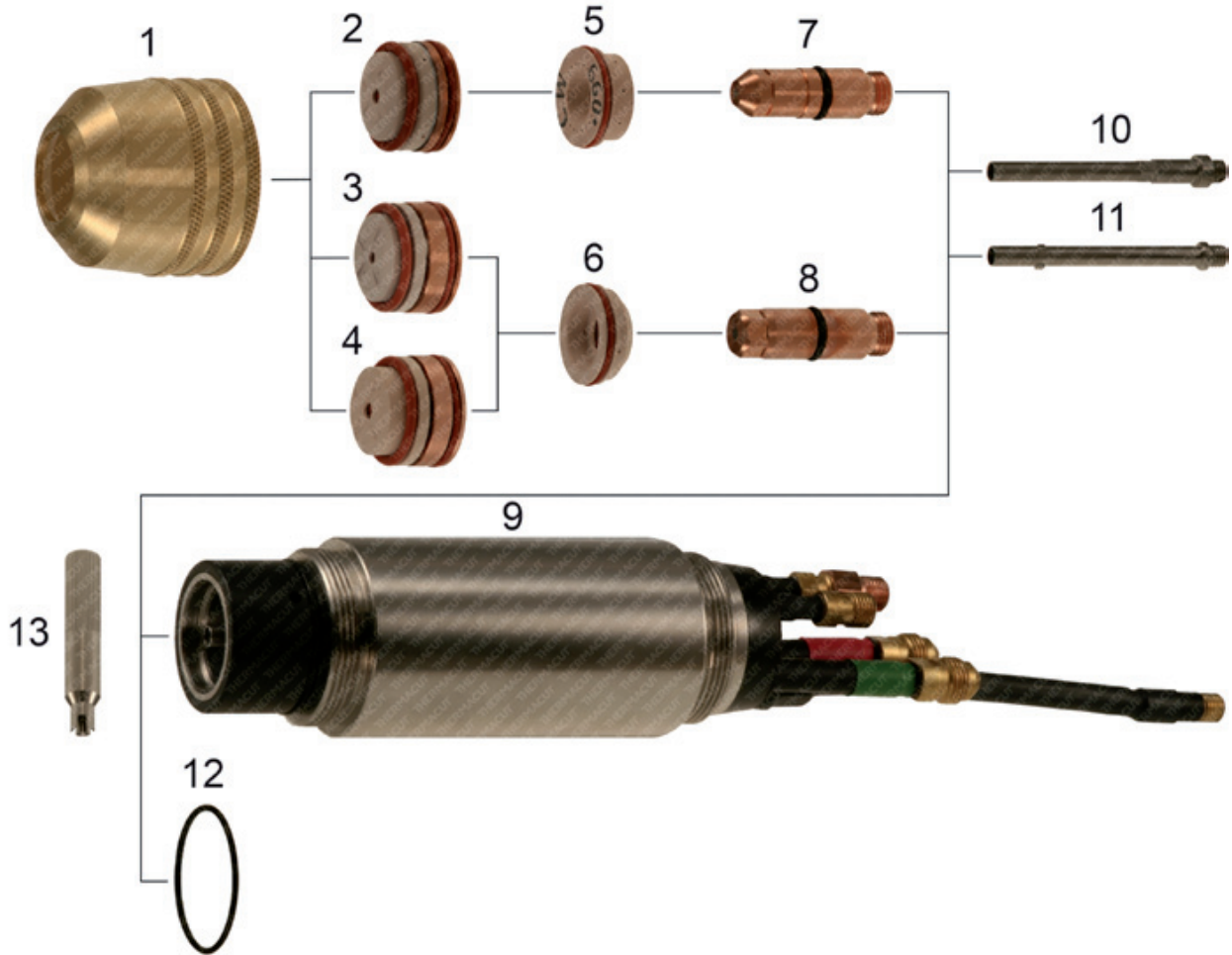

Item	Part No.	Ref. No.	Description	Std. Pkg.	Item	Part No.	Ref. No.	Description	Std. Pkg.
1.	T-0088	020579	Cap, Nozzle Retaining	1	**11.	T-1388	020990-UR	Water Tube: PAC400®/PAC600®/PAC170® (For TMT Torch)	1
2.	T-0078	020086	Nozzle, .099 Oxygen	1	12.	T-1006	044028	O-Ring	1
3.	T-0079	020089	Nozzle, .120 Nitrogen	1	13.	T-1397	T-1397	Wrench for TMT Water Tube	1
4.	T-0080	020084	Nozzle, .166 Nitrogen	1	NS	KT-1214	028139	HT400®, PAC500® Cable Leads, 6,1m (20')	1
5.	T-0081	020096	Swirl Ring, Oxygen	1	NS	KT-1154	028140	HT400®, PAC500® Cable Leads, 7,6m (25')	1
	T-0087	020097	Swirl Ring, Oxygen, CCW	1	NS	KT-1157	028141	HT400®, PAC500® Cable Leads, 9,2m (30')	1
6.	T-0020	020039	Swirl Ring, Nitrogen	1	NS	KT-1153	028142	HT400®, PAC500® Cable Leads, 10,7m (35')	1
7.	T-0083	020081	Electrode, Oxygen	5	NS	KT-1404	028143	HT400®, PAC500® Cable Leads, 12,2m (40')	1
8.	T-0084	020082	Electrode, Nitrogen	5	NS	KT-1217	K.HT400.15,2M.K	HT400®, PAC500® Cable Leads, 15,2m (50')	1
9.	T-0085	020080	Torch Body HT400®	1	NS	KT-1058	K.HT400.10,7M	HT400® Mach. Torch with Leads 10,7m (35')	1
#10.	T-1389#	020990 OEM	Water Tube: PAC400®/PAC600®/PAC170® (For OEM Torch)	1	Different types of cable leads available on request				

Compatible with OEM torch only, doesn't fit to Thermacut torch

** Compatible with Thermacut and OEM torch

NS Not shown in the picture

CCW Counter Clock Wise gas swirling, use of CCW parts will make cut angle on the opposite side, than with standard Counter Wise (CW) swirling parts.