

REPLACEMENT PARTS SUITABLE FOR HYPERTHERM®

HT40®
PAC140/M®

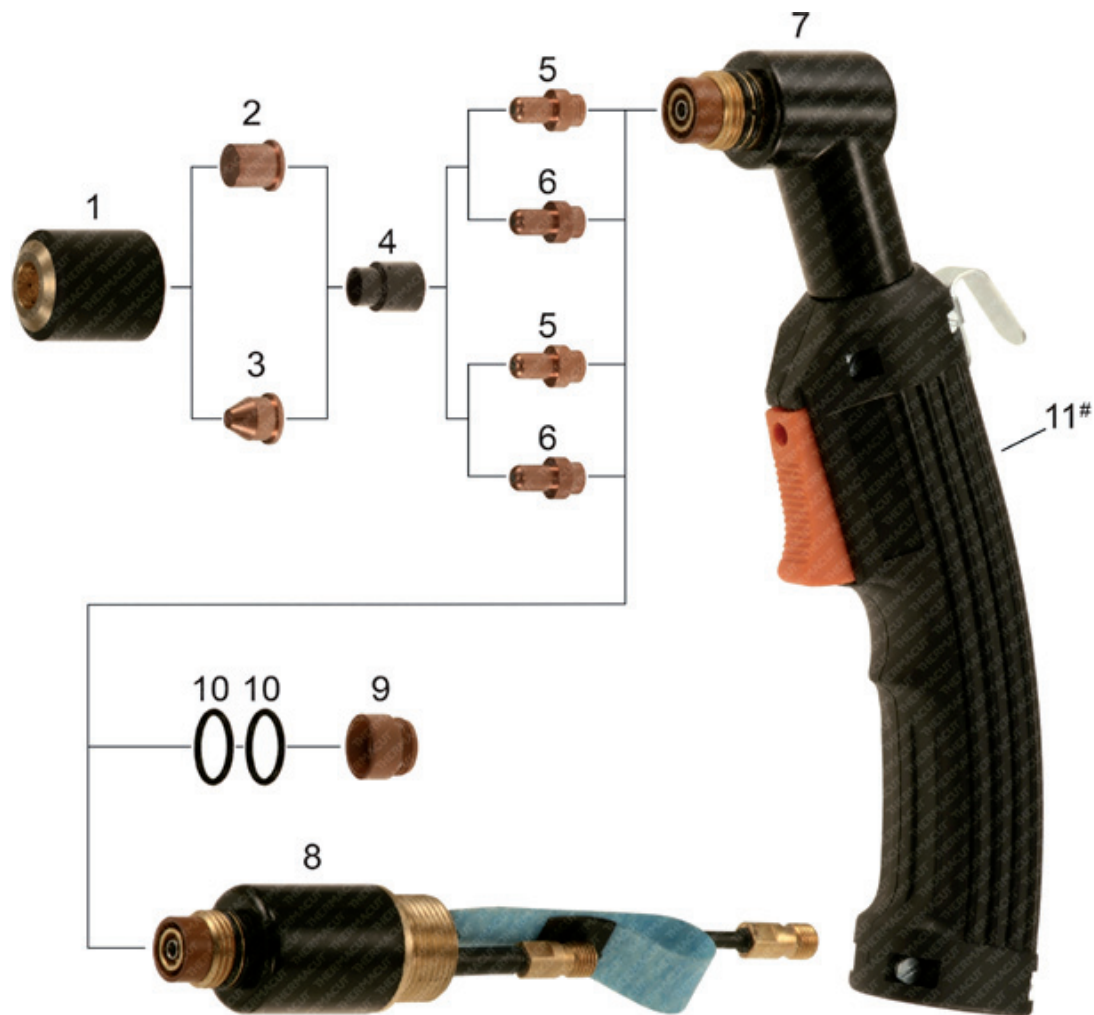

Item	Part No.	Ref. No.	Description	Std. Pkg.	Item	Part No.	Ref. No.	Description	Std. Pkg.
1.	T-0043	020104	Retaining Cap, Standard	1	9.	T-0095	020114-1	Front Insulator	1
2.	T-0046	020102	Nozzle 40A	1	10.	T-0038	044016	O-Ring	1
3.	T-0047	020131	Nozzle, Pipe Saddle	1	#11.	T-1040#	9-5636-1	Handle	1
4.	T-0051	020101	Swirl Ring	1	NS	KT-1229	K.PAC140H.5M	PAC140/H® Hand Torch with Lead 5m (16')	1
5.	T-0053	020167	Electrode, Nitrogen	5	NS	KT-1210	057112	PAC140/H® Hand Torch with Lead 7,6m (25')	1
6.	T-0052	020103	Electrode, Air	5	NS	KT-1261	057113	PAC140/H® Hand Torch with Lead 15,2m (50')	1
7.,11.	T-0055	020122	PAC140® Hand Torch + Handle	1	NS	KT-1084	028290	PAC140/M® Cable Leads, Mach.15,2m (50')	1
8.	T-0056	020114	PAC140/M® Machine Torch	1	Different types of cable leads available on request				

ONLY FOR THERMACUT TORCH DESIGN

NS NOT SHOWN IN THE PICTURE

MAX40® and HT40® parts are fully interchangeable in case of need.

HYPERTHERM®, MAX40®, HT40®, PAC140®, PAC140/M®, PAC140/H® are the Registered Trademarks of HYPERTHERM, Inc.

Last update of this page: 16/08/2014. See Revision history for details.