

REPLACEMENT PARTS SUITABLE FOR HYPERTHERM®

HPR130®/HPR260®
Torches and Cable leads

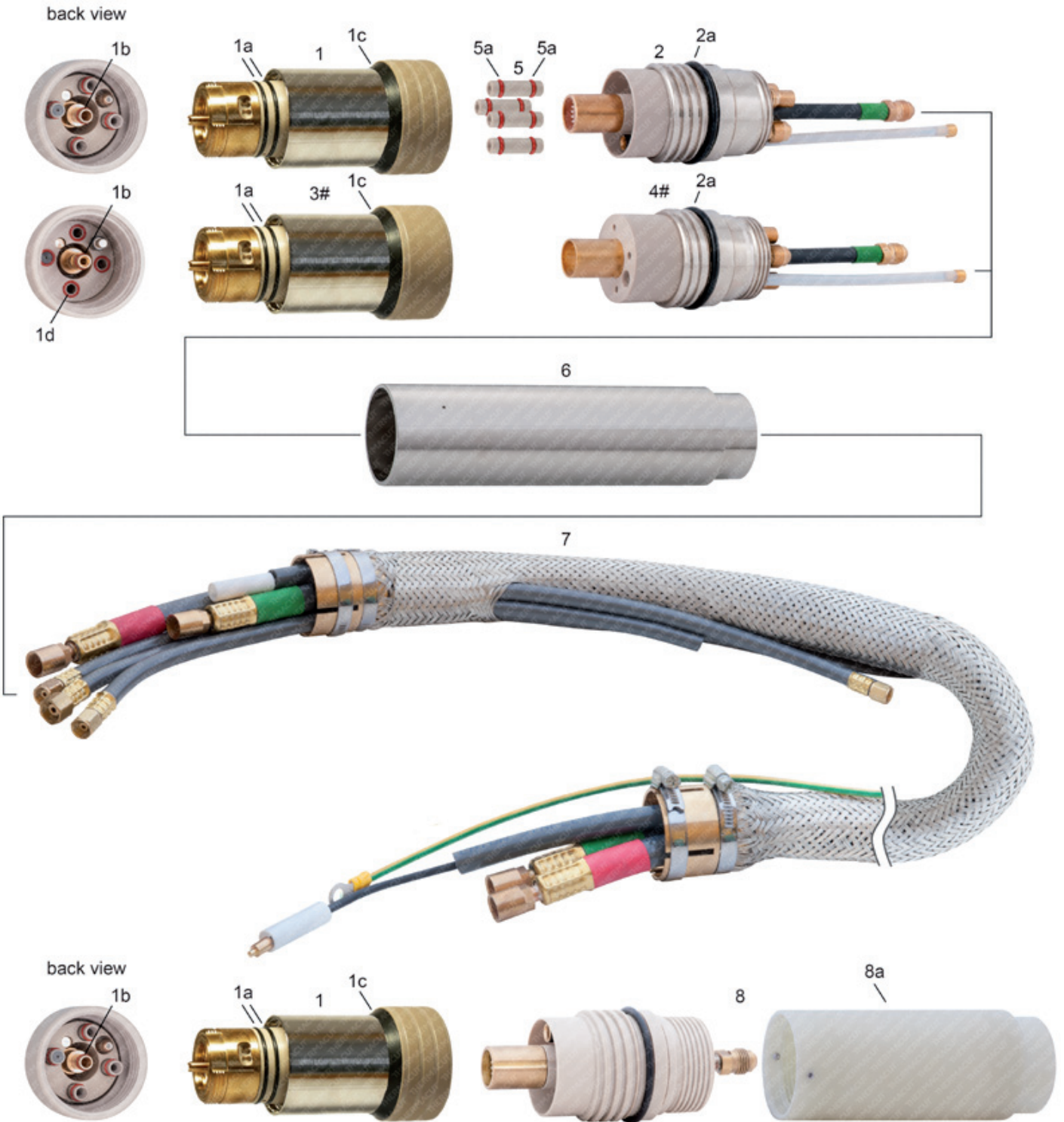

HYPERTHERM®, HyPerformance™ Plasma, HPR130®, HPR260® are the Registered Trademarks of Hypertherm, Inc.

Last update of this page: 13/04/2015. See Revision history for details.

REPLACEMENT PARTS SUITABLE FOR HYPERTHERM®

HPR130®/HPR260®

Torches and Cable leads

Item	Part No.	Ref. No.	Description	Std. Pkg.	Item	Part No.	Ref. No.	Description	Std. Pkg.
1., 5.	T-11137	220162	Torch Q. D. Orig. design (incl.item 5; included 2pcs cooling tube 220340-UR)	1		KT-1150	128988	Cable Leads 20m (65ft)	1
1a.	N-10096	1-028B	O-Ring	1		KT-1270	K.HPR130.21M.K	Cable Leads 21m (69ft)	1
1b.	N-10054	1-008S	O-Ring	1	!!!	KT-1245	DEMO_HPR130	Torch + cable leads 0,8m, for exhibition only,inoperative!	1
1c.	N-18157		Conical Sealing	1	1,2,5,6,7	KT-1331	K.HPR130.7,5M	Torch with Leads 7,5m (25ft)	1
1d.	N-10534	60-246S	O-Ring	1	3,4,6,7	KT-1066	K.HPR130.7,5M-UR	Torch -UR with Leads 7,5m (25ft)	1
2.	T-11138	220163	Receptacle Q. D. Original design	1	3,4,6,7	KT-1082	K.HPR130.15M-UR	Torch -UR with Leads 15m (50ft)	1
2a.	N-18108	N-18108	O-Ring	1	3,4,6,7	KT-1076	K.HPR130.18M-UR	Torch -UR with Leads 18m (59ft)	1
#3.	T-10200#	220162-UR	Torch Q. D. Thermancut design (included 2pcs cooling tube 220340-UR)	1	3,4,6,7	KT-1421	K.HPR130.20M	Torch with Leads 20m (65ft)	1
#4.	T-10201#	220163-UR	Receptacle Q. D. Thermancut design	1	3,4,6,7	KT-1075	K.HPR130.21M-UR	Torch -UR with Leads 21m (69ft)	1
5.	T-11769	T-11769	Connector Tube HPR with O-Rings	1					
5a.	N-10055	1-009S	O-Ring	1	1a, 1b, 1c, 5, 5a	T-11864	128879	Set of spare parts for 220162, contains items 5 (4pcs), 5a (8pcs), 1a (2pcs), 1b (1pc), 1c (1pc), cooling tube 220340-UR, silicon grease T0994	1
6.	T-10492	220232	Mounting Tube	1					
7.	KT-1108	128986	Cable Leads 2m (6ft)	1					
	KT-1397	128935	Cable Leads 3m (10ft)	1					
	KT-1117	128934	Cable Leads 4,5m (15ft)	1	1a, 1b, 1c, 1d	T-11207	128879-UR	Set of spare parts for 220162-UR, contains items 1a (2pcs), 1b (1pc), 1c (1pc), 1d (4pcs), cooling tube 220340-UR, silicon grease T0994	1
	KT-1052	128784	Cable Leads 7,5m (25ft)	1					
	KT-1126	128987	Cable Leads 10m (35ft)	1					
	KT-1106	128785	Cable Leads 15m (50ft)	1	##8.	T-11409##	220573	Receptacle Q.D., Bevel	1
	KT-1269	K.HPR130.18M.K	Cable Leads 18m (59ft)	1	##8a.	T-11410##	220546	Torch mounting sleeve, Bevel	1

MUST BE USED ONLY AS A SET OF ITEMS 3 AND 4, THIS COMPLETE SET IS INTERCHANGEABLE AND COMPATIBLE WITH ORIGINAL PARTS

RECEPTACLE Q.D., BEVEL POS. 8 IS NOT COMPATIBLE WITH STANDARD CABLE LEADS POS. 7

!!! DEMO IS INOPERATIVE, FOR EXHIBITION PURPOSES ONLY!

NS NOT SHOWN IN THE PICTURE

Q.D.QUICK DISCONNECT

ALL PARTS ARE WITH O-RINGS