

REPLACEMENT PARTS SUITABLE FOR ESAB®/L-TEC®

PT-31XL®

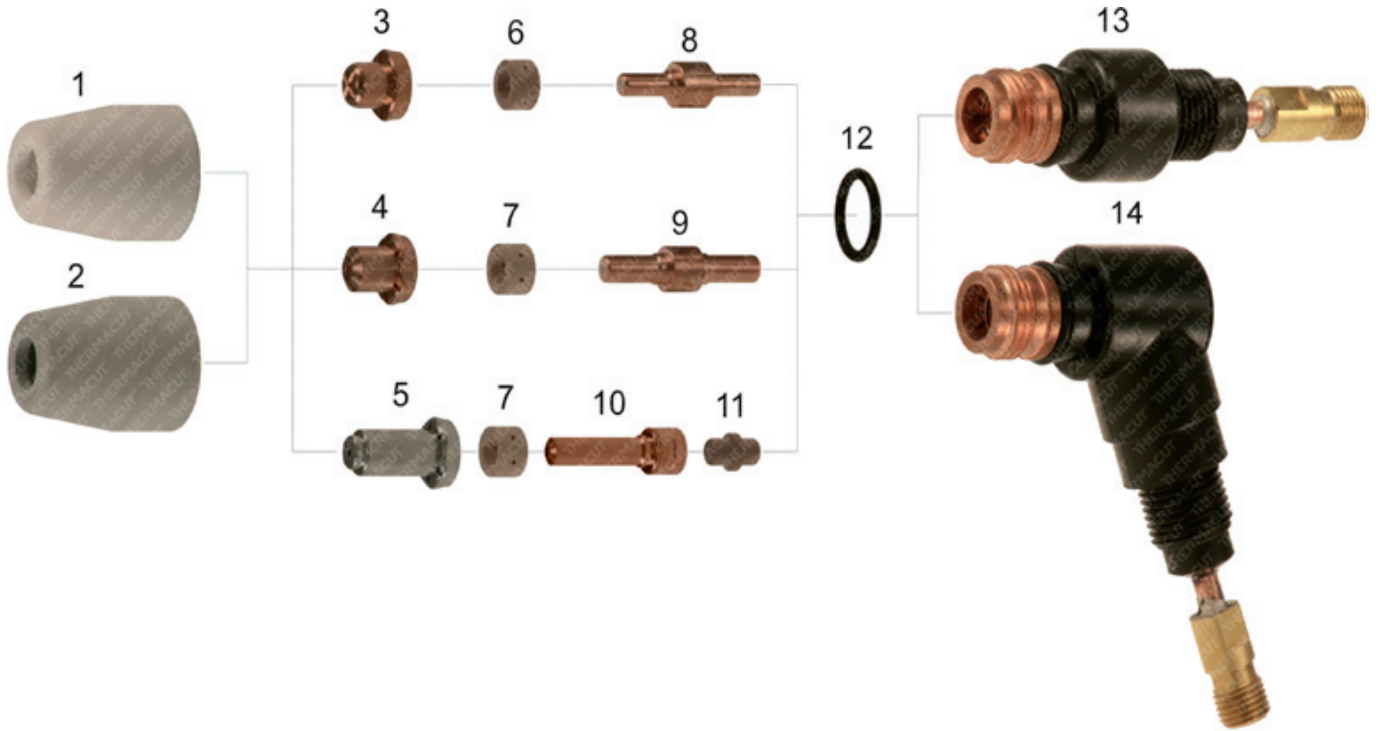

Item	Part No.	Ref. No.	Description	Std. Pkg	Item	Part No.	Ref. No.	Description	Std. Pkg.
1.	T-0289	18204	Heat Shield	1	8.	T-0295	18205	Electrode Standard	5
2.	T-0290	20282	Heat Shield	1	9.	T-0296	19683	Electrode Heavy Duty	5
3.	T-0291	18866	Nozzle 30A	1	10.	T-1173	20862	Electrode XT	5
4.	T-1297	20079	Nozzle 50A	1	#11.	T-1172#	20324	Plunger	1
5.	T-1174	20860	Nozzle XT 30-40A	1	12.	T-0357	950790	O-Ring	1
	T-1176	20861	Nozzle XT 50A	1	13.	T-0298	20073	Torch Body - Machine	1
	T-1175	21008	Nozzle 35-40A	1	14.	T-0297	20072	Torch Body 70° - Hand	1
6.	T-0293	18785	Swirl Baffle	1	NS	KT-1339	0558003183	PT-31XLPC® Torch with Leads, 7,6m (25')	1
7.	T-0294	20463	Swirl Baffle	1					

ONLY FOR OEM TORCH.

ESAB®, PT-31XL® are the Registered Trademarks of ESAB. L-TEC® is the Registered Trademark of L-TEC® Cutting Systems.

Last update of this page: 16/10/2014. See Revision history for details.