

REPLACEMENT PARTS SUITABLE FOR CEBORA®

CP160®

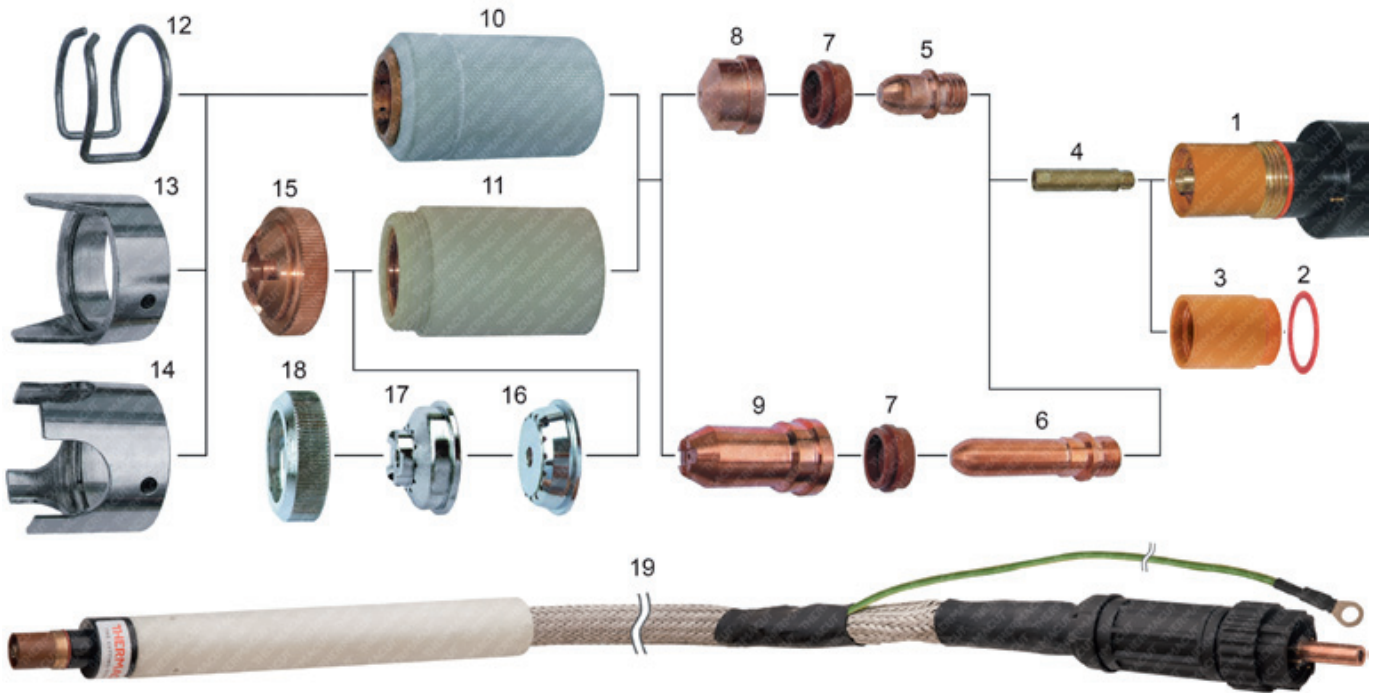

Item	Part No.	Ref. No.	Description	Item	Part No.	Ref. No.	Description
1.	T-8955	1353	Torch Body - Hand	12.	T-0400	1386	Spacer Spring
	T-8746	1354	Torch Body - Machine	13.	T-0643	1408	Double Pointed Spacer
2.	T-0411	1398	O-Ring	14.	T-5003	CV14	Crown Spacer
3.	T-9377	40941	Torch Insulator	15.	T-5401	1392	Shield Cup
4.	T-0410	1378	Air Diffuser	NS	T-5442	1356	Handle with Switch
5.	T-0408	1376	Electrode	16.	T-9372		Shield Cup, machine
6.	T-0409	1517	Electrode, Long	17.	T-9370		Spacer for contact cutting
7.	T-0407	1377	Swirl Ring	18.	T-9375		Locking Nut
	T-8959	1377-CW	Swirl Ring	NS	KT-1048	1576	CP160-H® Torch with Leads 6m with centr. conn.
8.	T-0402	1371	Nozzle 1.1mm	NS	KT-1057	1571	CP160-H® Torch with Leads 6m, fittings
	T-0403	1372	Nozzle 1.3mm	NS	KT-1070	K.CP160H.6M.CK.K	CP160-H® Cable Leads, Hand.6m with centr. conn.
	T-0404	1373	Nozzle 1.6mm	NS	KT-1083	1578	CP160-H® Hand Torch with Leads 12m with centr. conn.
	T-0405	1374	Nozzle 1.8mm	19.	KT-1128	1577	CP160-M® Mach.Torch with Leads 6m with centr. conn.
9.	T-0406	1369	Nozzle, Long		KT-1273	K.CP160M.12M.CK.K	CP160-M® Cable Leads, Mach.12m with centr. conn.
10.	T-0401	1389	Retaining Cap HP, MP150		KT-1086	1579	CP160-M® Mach. Torch with Leads 12m with centr. conn.
11.	T-5400	1390	Contact Nozzle Ret. Cap HP,MP150				Different types of cable leads available on request

CEBORA®, CP160® are the Registered Trademarks of CEBORA S.p.A.

Last update of this page: 03/09/2014. See Revision history for details.